

## Items Included in Your Collection Kit

STOOL COLLECTION

- 1 – Test Requisition Form
- 1 – Zip Closure Specimen Bag
- 1 – Collection Tray
- 1 – Absorbent Pad
- 1 – Specimen Vial
- 1 – Prepaid return envelope
- 2 – Gloves

*\* Avoid contact with skin and eyes to the specimen vial fluid. If you do get fluid in your eyes, flush eyes with water for 15 minutes. If your skin comes in contact with vial fluid, wash with soap and water. If ingested, please contact a physician.*

## STOOL COLLECTION INSTRUCTIONS

FOLLOW INSTRUCTIONS CAREFULLY – IMPROPER COLLECTION MAY INVALIDATE RESULTS

1



\* No ID Number — Use space for Date of Birth

**NOTE:** Please review all instructions and collection kit components before starting your sample collection. **DO NOT** discontinue taking prescription medications unless directed by your physician.

Write your Name, Date of Birth (*on ID Number line*), and Collection Date on the Specimen Vial.

2



*If possible, void urine prior to collecting stool to avoid mixing it with your stool sample.*

Put gloves on and pass stool into provided Collection Tray.

3

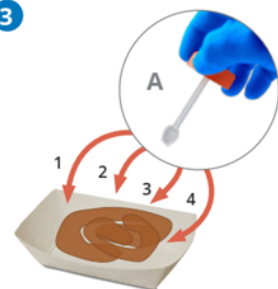

**DO NOT DISCARD THE PINK LIQUID IN THE SPECIMEN VIAL.**

**A)** Using the spoon attached to the cap of the Specimen Vial, spoon stool from multiple areas of the sample into the vial.\*

*\* Collect from at least 4 areas going left to right.*

**B)** Fill Specimen Vial to the red "Fill Line" indicated on label.

*Failure to add sufficient sample may result in the laboratory not being able to process the sample.*

4



**A)** Carefully mix stool and fluid with the spoon attached to the cap.

**B)** Replace cap tightly and shake vial vigorously for 30 seconds.

5



**A)** Fill out the Test Request Form completely and place form into the document holder of the Specimen Bag.

**NOTE:** Be sure to write the date of sample collection and sign the form.

**B)** Place capped Specimen Vial containing the collected stool sample into the Specimen Bag along with Absorbent Pad and seal the bag.

**C)** Place the Specimen Bag with the collected sample and Test Requisition Form in the Kit Box.

**D)** Ship completed Kit Box directly to the lab using the pre-paid return envelope.

See shipping instructions below.\*\*

**\*\* Sample must be received within 6 days of collection.** If you cannot ship the specimen on the day of collection, please refrigerate and ship as soon as possible, preferably within 3 days.